



Catalog Number	See Table
UPC Number	See Table
Description	Copper Long Barrel 2 Hole Compression Connector

Features

- Manufactured from High Strength High Conductivity Seamless Copper Tubing
- Electro-Tin Plated
- Color coded & Marked with die size and crimp marks
- Peep Hole



General

Wire Size:	#8 Str thru 750 MCM
Material:	High Conductivity Seamless Copper Tubing
Material Treatment:	Electro-Tin Plating
Stud Configuration:	2 Hole
Stud Size:	See Table
Stud Spacing:	

Dimension Information

See Table

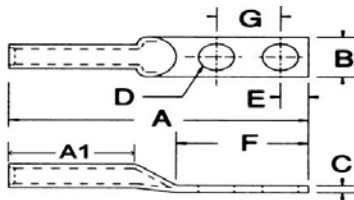

Specifications

Temperature Rating	90° C
Voltage Rating	35 KV
Flammability Rating	N/A
Amp Rating	To Conductor

Packaging

Box Qty	See Table
---------	-----------

Certifications

UL	UL486A
cUL	Yes
RoHS	Yes

Copper Short Barrel 1 Hole Compression Connector

Cat No.	Wire Range	Stud Size	Hole Spacing	Color	Box Qty	A	A1	B	C	D	E	F	G
94310	8 Str.	#10	5/8	Red	45	2.32(59.0)	.75(19.1)	.42(10.7)	.08(2.0)	.21(5.3)	.28(7.1)	1.25(31.8)	.625(15.9)
94312	8 Str.	1/4	5/8	Red	45	2.32(59.0)	.75(19.1)	.42(10.7)	.08(2.0)	.25(6.4)	.28(7.1)	1.25(31.8)	.625(15.9)
94316	6 Str.	1/4	5/8	Blue	35	2.68(68.0)	1.12(28.4)	.50(10.7)	.06(2.1)	.25(6.4)	.28(7.1)	1.25(31.8)	.625(15.9)
94324	4 Str.	1/4	5/8	Gray	25	2.76(70.0)	1.12(28.4)	.49(12.4)	.09(2.2)	.25(6.4)	.28(7.1)	1.25(31.8)	.625(15.9)
94326	4 Str.	1/2	1 3/4	Gray	30	4.49(114.0)	1.12(28.4)	.78(19.8)	.06(1.4)	.51(13.0)	.62(15.7)	3.00(76.2)	1.75(44.5)
94330	2 Str.	5/16	3/4	Brown	30	3.27(83.0)	1.25(31.8)	.60(15.3)	.10(2.6)	.33(8.4)	.32(8.1)	1.62(41.1)	.75(19.1)
94332	2 Str.	5/16	7/8	Brown	20	3.27(83.0)	1.25(31.8)	.60(15.3)	.10(2.6)	.33(8.4)	.32(8.1)	1.62(41.1)	.875(22.2)
94334	2 Str.	1/2	1 3/4	Brown	20	4.65(118.0)	1.25(31.8)	.81(20.5)	.08(2.0)	.51(13.0)	.62(15.7)	3.00(76.2)	1.75(44.5)
94338	1 Str.	1/4	5/8	Green	15	2.87(73.0)	1.25(31.8)	.67(17.1)	.11(2.7)	.25(6.4)	.28(7.1)	1.25(31.8)	.625(15.9)
94340	1 Str.	5/16	7/8	Green	30	3.27(83.0)	1.25(31.8)	.67(17.1)	.11(2.7)	.33(8.4)	.32(8.1)	1.62(41.1)	.875(22.2)
94342	1 Str.	1/2	1 3/4	Green	30	4.65(118.0)	1.25(31.8)	.78(19.8)	.09(2.3)	.51(13.0)	.62(15.7)	3.00(76.2)	1.75(44.5)
94346	1/0 Str.	5/16	7/8	Pink	25	3.39(86.0)	1.38(35.1)	.74(18.9)	.13(3.2)	.33(8.4)	.32(8.1)	1.62(41.1)	.875(22.2)
94348	1/0 Str.	3/8	1	Pink	25	3.58(91.0)	1.38(35.1)	.74(18.9)	.13(3.2)	.41(10.5)	.38(9.7)	1.81(46.0)	1.00(25.4)
94350	1/0 Str.	1/2	1 3/4	Pink	25	4.76(121.0)	1.38(35.1)	.78(19.8)	.12(3.1)	.51(13.0)	.62(15.7)	3.00(76.2)	1.75(44.5)
94354	2/0 Str.	3/8	1	Black	20	3.86(98.0)	1.50(38.1)	.81(20.7)	.12(3.0)	.41(10.5)	.38(9.7)	1.81(46.0)	1.00(25.4)
94356	2/0 Str.	1/2	1 3/4	Black	20	5.04(128.0)	1.50(38.1)	.81(20.7)	.12(3.0)	.51(13.0)	.62(15.7)	3.00(76.2)	1.75(44.5)
94360	3/0 Str.	3/8	1	Orange	15	3.98(101.0)	1.50(38.1)	.90(22.9)	.13(3.2)	.41(10.5)	.38(9.7)	1.81(46.0)	1.00(25.4)
94362	3/0 Str.	1/2	1 3/4	Orange	20	5.16(131.0)	1.50(38.1)	.90(22.9)	.13(3.2)	.51(13.0)	.62(15.7)	3.00(76.2)	1.75(44.5)
94366	4/0 Str.	3/8	1	Purple	12	4.09(104.0)	1.62(41.1)	1.00(25.4)	.13(3.4)	.41(10.5)	.38(9.7)	1.81(46.0)	1.00(25.4)
94368	4/0 Str.	1/2	1 3/4	Purple	20	5.28(134.0)	1.62(41.1)	1.00(25.4)	.13(3.4)	.51(13.0)	.62(15.7)	3.00(76.2)	1.75(44.5)
94372	250 MCM	3/8	1	Yellow	12	4.17(106.0)	1.62(41.1)	1.09(27.7)	.15(3.8)	.41(10.5)	.38(9.7)	1.81(46.0)	1.00(25.4)
94374	250 MCM	1/2	1 3/4	Yellow	15	5.35(136.0)	1.62(41.1)	1.09(27.7)	.15(3.8)	.51(13.0)	.62(15.7)	3.00(76.2)	1.75(44.5)
94378	300 MCM	1/2	1 3/4	White	12	5.79(147.0)	2.00(50.1)	1.19(30.2)	.15(3.8)	.51(13.0)	.62(15.7)	3.00(76.2)	1.75(44.5)
94382	350 MCM	1/2	1 3/4	Red	10	5.83(148.0)	2.00(50.1)	1.28(32.4)	.17(4.2)	.51(13.0)	.62(15.7)	3.00(76.2)	1.75(44.5)
94386	400 MCM	1/2	1 3/4	Blue	10	5.94(151.0)	2.00(50.1)	1.39(35.2)	.18(4.5)	.51(13.0)	.62(15.7)	3.00(76.2)	1.75(44.5)
94390	500 MCM	1/2	1 3/4	Brown	8	6.22(158.0)	2.25(57.2)	1.54(39.1)	.22(5.5)	.51(13.0)	.62(15.7)	3.00(76.2)	1.75(44.5)
94394	600 MCM	1/2	1 3/4	Green	6	6.57(167.0)	2.50(63.5)	1.72(43.6)	.25(6.4)	.51(13.0)	.62(15.7)	3.00(76.2)	1.75(44.5)
94398	750 MCM	1/2	1 3/4	Black	4	6.93(176.0)	2.88(73.2)	1.90(48.3)	.27(6.8)	.51(13.0)	.62(15.7)	3.00(76.2)	1.75(44.5)